

FIRST SCHEDULE
TREES SPECIFIED INDIVIDUALLY*
(encircled in black on the map)

No. on Map	Description	Situation
NONE	NONE	NONE

TREES SPECIFIED BY REFERENCES TO AN AREA*
(within a dotted black line on the map)

No. on Map	Description	Situation
NONE	NONE	NONE

GROUPS OF TREES*
(within a broken black line on the map)

No. on Map	Description	Situation
NONE	NONE	NONE

WOODLANDS*
(within a continuous black line on the map)

No. on Map	Description	Situation
W1	Woodland area consisting of beech, lime, cherry, maple, sycamore, ash, birch, whitebeam, hawthorne, oak, alder, rowan, holly, chestnut	Woodland at Throstle Croft, Saccary Lane, Mellor

* The word "NONE" must be entered where necessary

SECOND SCHEDULE

This Order shall not apply so as to require the consent of the authority to

(3) the cutting down of any tree on land which is
subject to a forestry dedication covenant where

- (a) any positive covenants on the part of the owner of the land contained in the same deed as the forestry dedication covenant and at the time of the cutting down binding on the then owner of the land are fulfilled;
- (b) the cutting down is in accordance with a plan of operations approved by the Forestry Commission under such deed.

(4) the cutting down of any tree which is in accordance with a plan of operations approved by the Forestry Commission under a grant scheme under section 1 of the Forestry Act 1979 except a scheme which applies to a forestry dedication covenant.

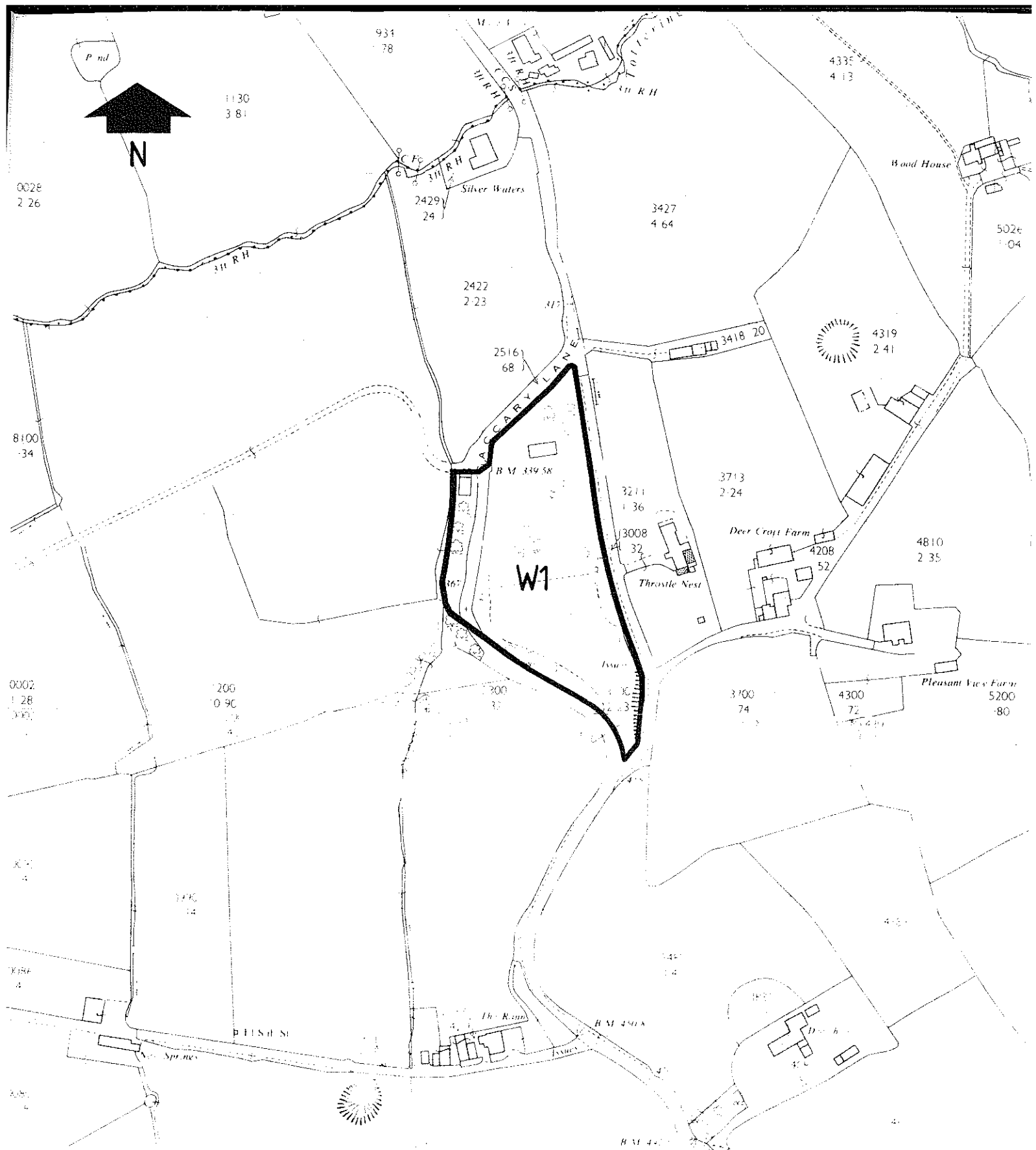

Ribble Valley Borough Council
 Tree Preservation Order
 Throstle Croft, Saccary Lane, Mellor.

scale
 1/ 2500 th

drawing number
 8:99:1

reference
 DH

date
 March 1993

Philip Bailey Dip Arch. Dip T.P. RIBA MRTPI MBIM Director of Development
 Ribble Valley Borough Council, Church Walk, Clitheroe, Lancs. BB7 2RA (STD 0200) 25111